

# Umbra

## User/Programming Guide - UM-305B Wireless Keypad

Brought to you by [www.UmbrellaMeshNetwork.com](http://www.UmbrellaMeshNetwork.com)



## Umbrella Mesh Network, LLC

510 W. Amador Ave., Las Cruces, NM 88005

(855) 602-5276 [Ben@UmbrellaMeshNetwork.com](mailto:Ben@UmbrellaMeshNetwork.com)



**This guide is to be used for programming  
of the Umbra UM-305B Wireless Keypad.**

**For further info, please contact  
Your installer**

## Table of Contents

Introduction & keypad Layout	4
First time power up & Indicator Lights	5
Function Keys	6
Sound Indicators	7
<b>WARNING</b>	<b>8</b>
Administrator & User Passcodes	9
Enroll/Delete RFID Proximity Card/Tags	10
Enroll/Delete Keypad user to Panel	11
Default codes & reference table	12

## Introduction—The Umbra UM-305B Wireless keypad

- The Umbra UM-305B Wireless keypad is a 100% wireless, rechargeable keypad for the Umbra Legacy and Umbra Integral.
- Without an external power source, the keypad has an approximate battery life of 1 year before it needs to be charged.
- Alternatively, the keypad can be connected via Micro USB for permanent power.
- The layout of the keypad with the associated indicators and function keys is shown below.

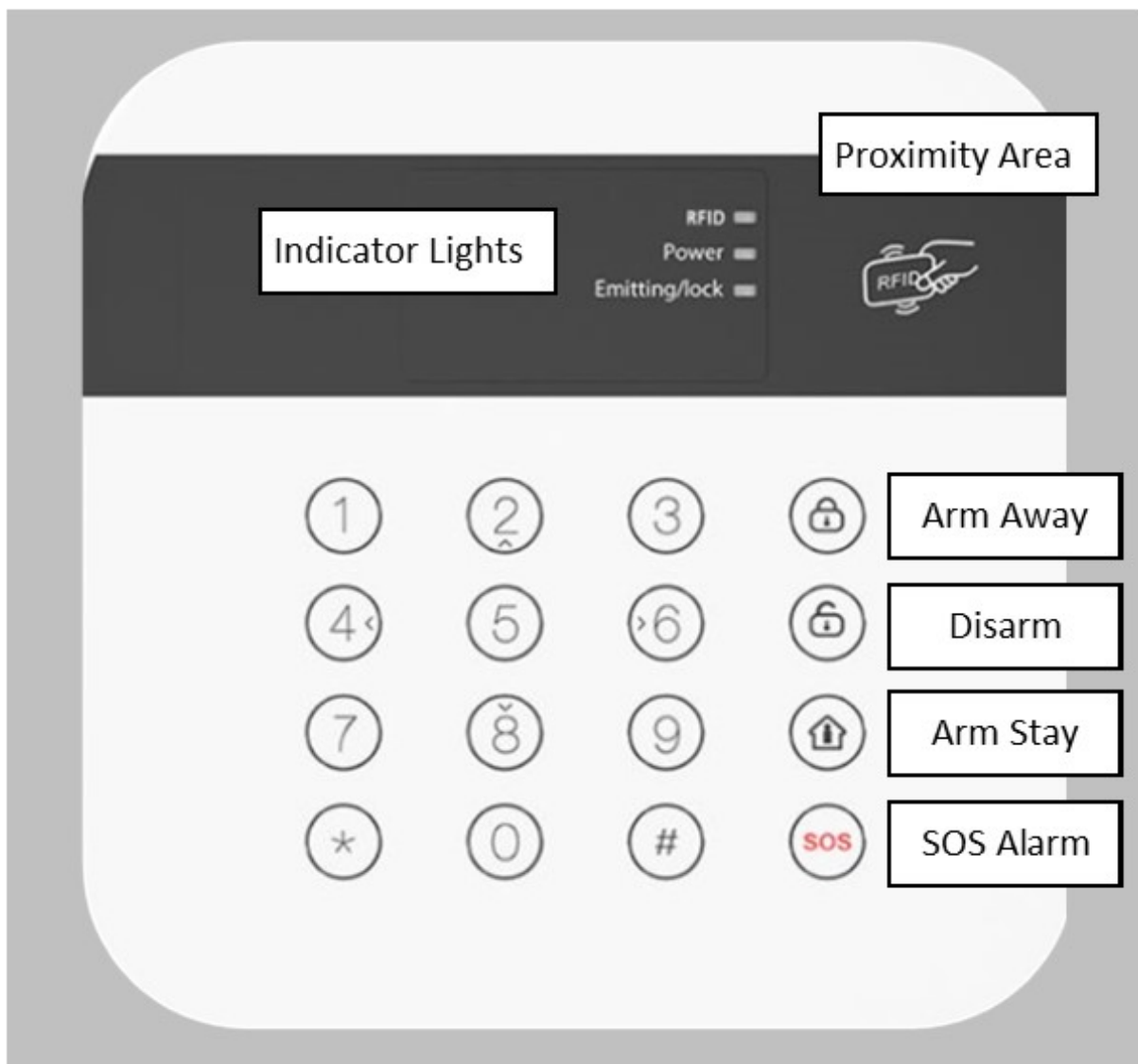

## First time power on

- To power on the keypad for the first time, press and hold the “#” and the “\*” together until the confirmation tone is heard.

## Indicator Lights

- The meaning of the indicator lights is as follows

Indicator	Light off	Light on	Flashing
RFID		Already Enrolled	Ready to read RFID Proximity Card/ Tag
Power	Battery Power	External Power Connected	Battery Low Power
Emitting/ Lock			Keypad Locked out for 3 min

Note: When not connected to a power source, the keypad needs to be “woken up” before a proximity tag can be presented.

Do this by pressing and holding the “\*” Key for 3 seconds

## Function Keys

- The use of the function keys is as follows



### Away Arm

- Press and hold for 3 seconds to activate Away arm function
- This function is to be used when there will be no one in the property and with all doors and windows closed.



### Home Arm

- Press and hold for 3 seconds to activate Home arm function
- This function is to be used when there will be movement inside the property but the perimeter sensors are to be armed.
- This is usually used when going to bed.



### Disarm

- Used to disarm the system after code has been entered



### SOS

- Press and hold for 3 seconds to activate emergency siren

## Sound Indicators

- The Umbra Legacy panel has a number of sound indications to inform the user via an audible prompt of the reaction of the panel to certain functions. These are listed below.

### **1 Short “Di”**

- RFID positive read
- Arm
- Correct operation

### **2 Short “Di, Di”**

- Correct Operation
- RFID positive read
- Disarm

### **5 Short repeating “Di, Di, Di, Di, Di”**

- Wrong operation
- RFID Already enrolled

### **Continuous “Buzz”**

- Tamper triggered
- Wrong code too many times
- SOS button triggered

# Caution!

The following pages are instructions for adding and removing devices/codes. Device changes should only occur after contacting your Security Alarm Service Provider.



## Programing

### Programing administrator passcode

The Administrator code is used to set the keypad parameters, add/remove codes and add/remove RFID Proximity Cards/Tags. It is not a user code.

- Enter the Administrator passcode (default is 888888) then press “0,0”
- Enter new installer passcode and then press “#” (make sure to note down what this password is, as it cannot be recovered without a full default of the keypad)

Example of administrator code change:

To change default code of “888888” to “012345”  
enter, 8,8,8,8,8,8,0,0,0,1,2,3,4,5,#

### Programing User passcodes—8 available

The User codes are used to arm & disarm the alarm panel associated with the keypad.

- Enter the Administrator passcode (default is 888888) then press the zone you wish to activate/deactivate or change from 01 for user 1 to 08 for user 8
- The next button pushes are to set weather the user is active or inactive.
- Press “0,1” to activate the user or “0,0” to deactivate the user
- Next enter the current 4 to 6 digit passcode or passcode you wish to change that user to followed by “#”

Example of code change & activation for user 1 using the default administrator passcode:

To activate user 1 and change default code of “011111” to “1234” enter, 8,8,8,8,8,8,0,1,0,1,1,2,3,4,#

## **Programing continued**

### **Programing RFID Proximity Card/Tag**

The keypad has the option to facilitate the use of up to 8 RFID proximity Cards/Tags

- Enter the Administrator passcode (default is 888888) then select option “9,0,#” to enter RFID enrollment.
- Press 1 to enroll RFID to user 1
- If the RFID indicator begins to steadily flash, present the RFID credential to the RFID “Proximity Area” to learn into this user slot.
- If the RFID indicator has a solid light, it means a credential is already learned into this spot.
- To delete an already learned in credential, while the RFID indicator is solid, hold the “\*” key for 3 seconds to delete.
- Press the next user number to learn in another RFID to a different user slot or press “#” to exit the enrolling menu.

### **Programing RFID Proximity Card/Tag function**

The RFID proximity Cards/Tags can be set to arm only, disarm only or arm and disarm.

**It is recommended that the RFID tags only be used to disarm the system associated with the wireless keypad and the “away” or “Stay” function buttons are used to arm the associated alarm system using the wireless keypad.**

- Enter the Administrator passcode (default is 888888) then select option “0,9” to enter RFID authority menu.
- Enter “0,0” to set as disarm, “0,1” to set to arm or “0,2” to set to arm and disarm
- Press “#” to save and exit.

## Enroll wireless keypad users into alarm panel using panel keys

- With the Umbra Legacy panel in the disarmed state, press and hold the “Enroll” button for 3 seconds. The panel will emit the “correct operation” short “Di” and the display will flash “E1” if the slot is available. If the slot is not available, the display will show “E1” steady.
- To enroll a wireless keypad user into this slot if it is available, trigger the device by entering the user code followed by the “Away” function key on the keypad.
- To enroll a wireless keypad user into a different slot, press the “WiFi” button to go to the next slot and the display will show the next device slot. **Press “Enroll” button 4 times to exit at any time.**

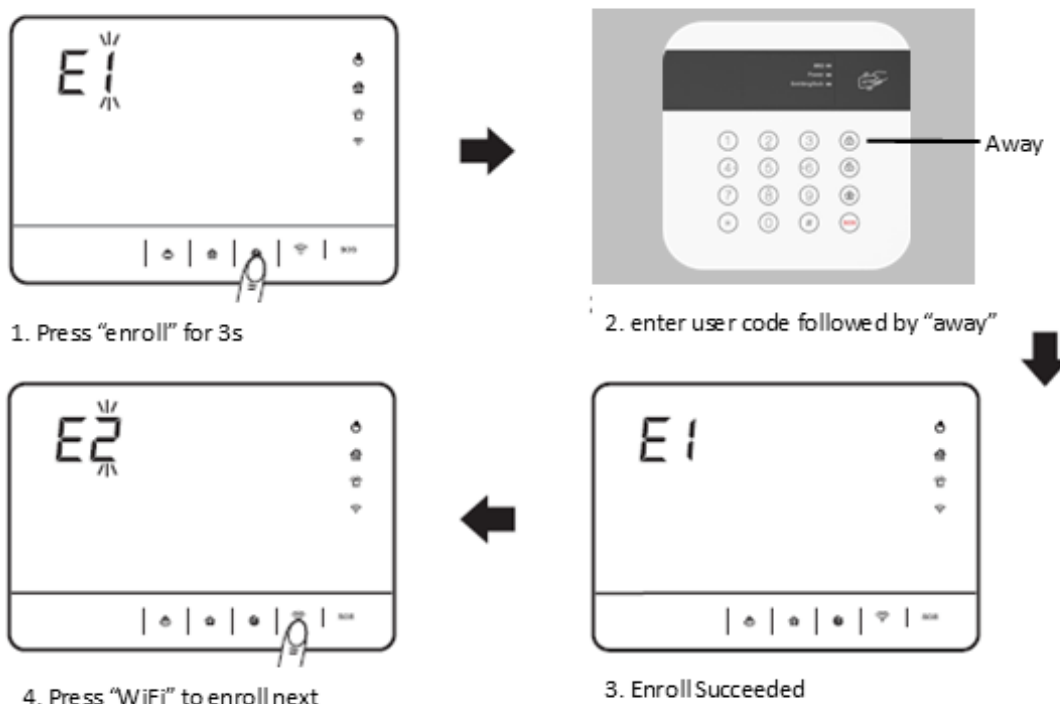

## Delete Wireless Keypad User from Panel

- With desired slot selected on display—press and hold “WiFi” button for 3 seconds to delete

## Default Codes

- When purchased separately, The Umbra UM-305B comes with pre-programmed default User codes disabled
- Please refer to the table below for the default codes and Functions

Address	User/Function	Factory Default
00	Administrator	8888888
01	User 1	011111
02	User 2	012222
03	User 3	013333
04	User 4	014444
05	User 5	000000
06	User 6	000000
07	User 7	000000
08	User 8	000000
09	RFID Authority	00
90	RFID Enroll	
99	Factory Default	

To default all codes back to factory, please perform the following action

- Enter the current Administrator passcode followed by “9,9” and then press “#”

If the current Administrator passcode is unknown please perform the following action

- Apply power to the micro USB slot and hold the “\*” and “#” keys together for 15 seconds
- If function is successful there will be a confirmation sound and the defaults will be restored. If unsuccessful, please try again.